



## ACO POINT DRAIN

### ***Point Drain Made of Plastic / Stainless Steel***

ACO floor drains are available in a clearly structured range to help simplify choice and combination to create a tailor-made system – the right system for your needs. Our floor drains come in a wide range of standard sizes. They are supplied complete and ready to install. The drain body can be enhanced with a complementary range of practical accessories – creating customized solutions to fit basically all situations as they occur in homes and buildings.

ACO floor drains are designed to provide hygienic, quick, simple and economic trapped drainage solutions for washrooms, 'wet' bathrooms, changing rooms, swimming pools, hotels, apartments and toilets. ACO point drains can be installed on all floor finishes including all cementitious and resin screeds, ceramic tiles, flexible vinyl sheet in solid and suspended flooring applications.

#### ***Typical Applications***

- Washrooms
- Wet bathrooms
- Toilets
- Changing rooms
- Leisure centres
- Swimming pools
- Hotels
- Apartments



### Easy Flow Floor Drain

The floor drains from ACO are modular systems and can therefore be put together in various combinations. This allows perfect functional solutions to be realised for specific installation situations and areas of application. ACO floor drains are used in all private wet-rooms and can be used in combination with appropriate seals and working as a reliable and efficient drainage system.

In addition to their many areas of application, ACO drains are also winners in terms of hygiene and simple cleaning. The foul air trap can be easily removed for unrestricted access to the pipes. Top section can be rotated and height adjustable by simply cutting it on site.

All ACO floor drains are produced according to DIN EN 1253.

All ACO floor drains are suitable for applications in single family dwellings and apartment buildings, wet rooms in hotel and old people's home.

#### Advantages of Easy Flow Drain

- Range designed for different tile thickness and floor structure heights
- Optimum pipeline access after removal of foul air trap
- Drain with inlet connection available optionally
- Light (LED) option available for S.S. grating
- Option with / without Flange
- Outlet socket for all Push-fit joints
- Outlet diameter available with DN50/DN70/DN100
- Ready to Install
- Height varies from 89mm to 263mm
- Different variety of grating options
  - Square grating with optional lock
  - Round grating
  - Tile grating
  - Designer glass grating

### EG150 Floor Drain

The stainless steel floor drains from ACO include the features of compact design, removable in-line foul air trap fitted as standard. The outlet can be vertical or horizontal spigot outlet. The height can be adjusted with telescopic height adjustment and full rotational alignment. Optional damp proof membrane bonding flanges available for the ultimate in sub-floor security.

Optional back inlet facilities provided to accept hand basin and condensate waste pipes.

Manufactured from austenitic 304 grade stainless steel as standard, excellent corrosion resistance is guaranteed. Optional 316 grade stainless steel for aggressive applications is available on all gullies. All ACO EG150 gullies are supplied with perforated gratings as standard ensuring no risk to bare feet or stiletto heels.

#### Advantages of EG150 Drain

- Compact design ideal for reconstruction
- Flexible installation due to rotatable and adjustable top section
- Removable foul air trap for easy cleaning and maintenance
- Available for cementitious/resin screed and tile applications, damp proof membrane bonding or vinyl sheet flooring
- Material S.S. 304
- Suitable for all push-fit joint systems
- Ready to Install
- Optionally available with side inlet connections
- Height varies from 52mm to 310mm
- Outlet diameter available with DN32/DN50
- Grating surface is Silk gloss
- Suitable for public area's due to locked grating



### Easy Flow Floor Drain

#### Flowrate

- Horizontal outlet, FAT with 50mm water seal - 1.5l/s
- Vertical outlet, FAT with 50mm water seal - 1.6l/s
- Horizontal outlet, FAT with 30mm water seal - 0.8l/s

Installation example

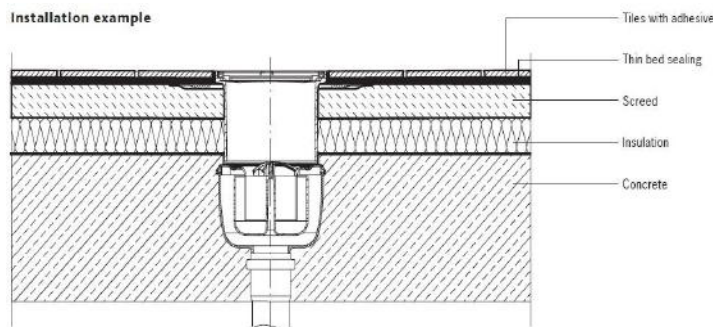

### EG150 Floor Drain

#### Flowrate

- Horizontal outlet, FAT with 50mm water seal - 1.20l/s
- Vertical outlet, FAT with 50mm water seal - 1.20l/s
- Horizontal outlet, DN32 without FAT - 0.75l/s

Installation example

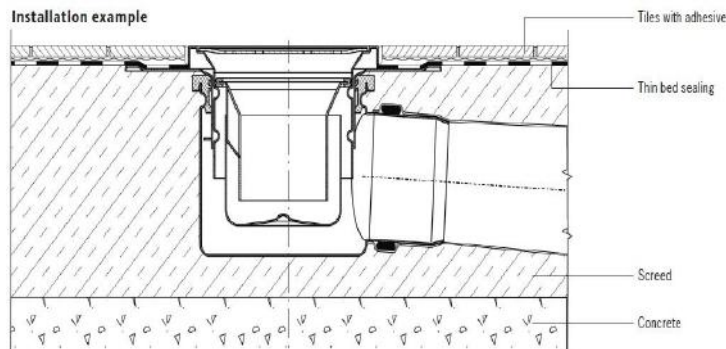

### ACO Systems and Solutions Pvt. Ltd.

1st Floor, Fathima Towers,  
No. 19, Rhenius Street, Langford Town  
Bangalore 560025, Karnataka, India

Tel. +91 80 22485487 / 88  
Fax +91 80 22485491  
acoindia@acosystems.in

[www.aco.in](http://www.aco.in)

